



METAL SEAL BALL VALVE



**TIANJIN FREYA AUTOMATION
TECHNOLOGY CO., LTD.**

Tell: 022-27901003

Mail: tjfreya@tj-bnd.com

Web: www.tj-bnd.com

Add: Industrial Park, Zhongbei Town, Xiqing District, Tianjin

**TIANJIN FREYA AUTOMATION
TECHNOLOGY CO., LTD.**

Company profile-----1/1
 Qualifications-----2/2
 Features & benefits of ball valve-----3/3
 Ball valves-----4/4
 GB ball valve-----5/12
 Side mounted eccentric ball valve-----13/15
 V port ball valve-----16/18
 All welded ball valve-----19/22

METAL SEAL BALL VALVE

Founded in 2014, Freya specializes in fluid control products and services such as valves, actuators, electric valve actuators, and electric valves. It focuses on the process industry and has long been committed to providing services to process industries such as power, steel, building materials, and water treatment to provide professional fluid control solutions. Based on the actual working conditions, through necessary on-site surveying and technical explanations, we provide customers with safe, economical and environmental-friendly selection and design, supply in strict accordance with contract requirements and guide installation and debugging, and hand over for use if standards are met. Thanks to the trust of the vast number of users, through long-term and large-scale on-site services, and the effective accumulation of technical experience, the company has an accurate understanding of the real needs and pain points of users and the market, as well as expectations for equipment manufacturers.

The company based on its own patent R & D and production of intelligent electric actuators, reliable, durable, easy to use, cost-effective and guaranteed service. Being close to users, providing full-process services, cover-all services, repair and maintenance value-added services, and escorting users' production are our differentiating advantages. Freya intelligent electric actuator and electric valve actuator provide a two-year warranty and lifetime free after-sales service after installation and commissioning. Technical quality and commercial credit are the two foundations on which the company relies to survive and drive the development of the company. Users feel reassured, worry-free and happy, which are the only criteria to evaluate the effectiveness of our work and demonstrate the value of our existence.



Ball Valves are available in one-piece, two-piece and three-piece constructions. In these valves, line pressure forces the floating ball against the downstream seat to effect bubble-tight sealing.

Blowout Proof Stem

The side-entry stem of ball valves has a shoulder that bears against a matching shoulder in the body to make it blowout proof - the higher the line pressure, the better the sealing to atmosphere.

High Integrity Stem Sealing

Sealing to atmosphere is further enhanced by stem thrust seals and stem packing rings. To compensate for wear and thermal expansions, belleville springs are used.

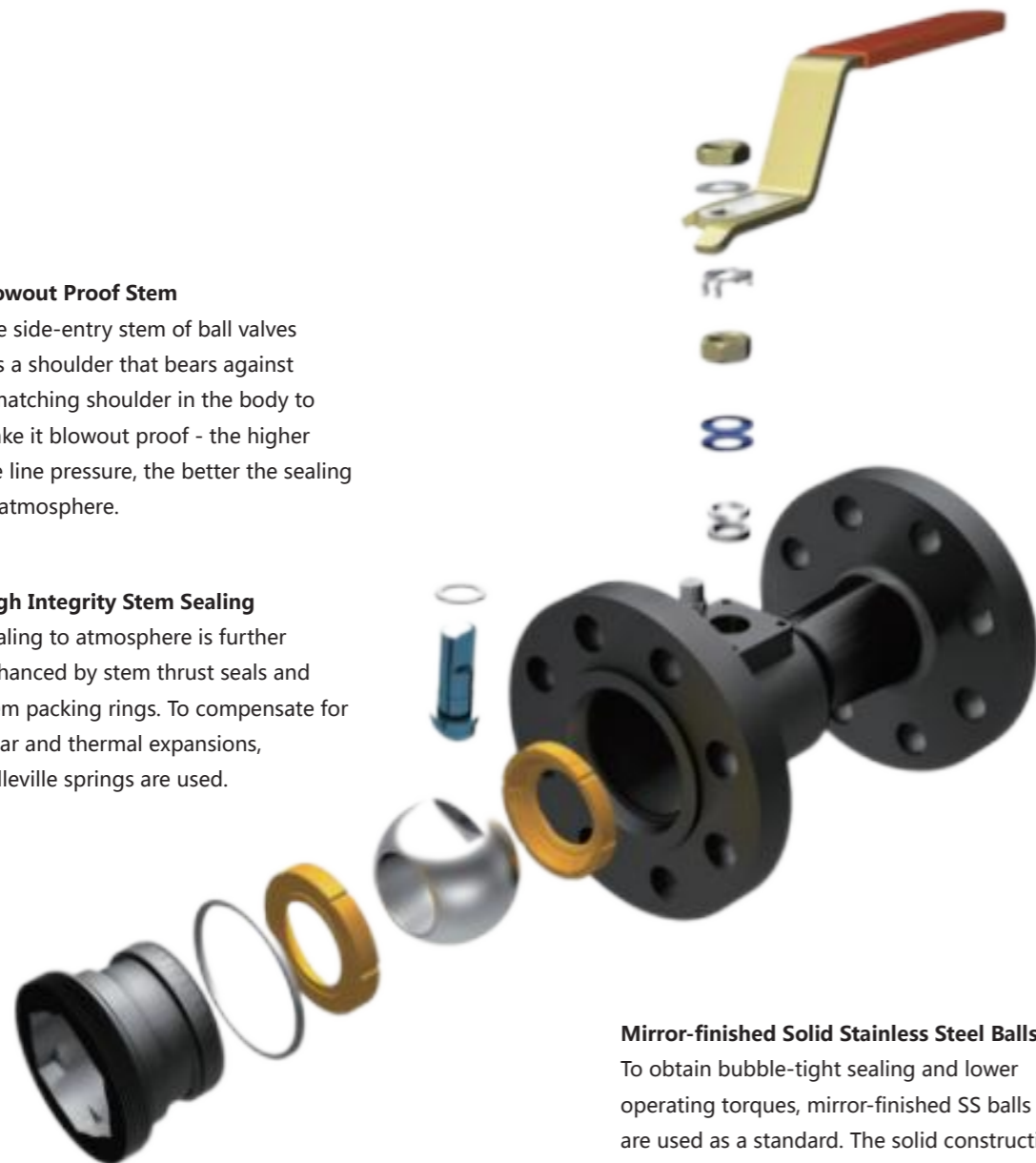

Mirror-finished Solid Stainless Steel Balls

To obtain bubble-tight sealing and lower operating torques, mirror-finished SS balls are used as a standard. The solid construction of the balls guarantees higher structural strength.

Seats with Pressure-relieving Slots

Seats with fine grain structure are used to ensure better strength and longer life. Pressure-relieving slots are a unique feature of ball valves. The slots relieve upstream pressure when the valve is in closed position and prevent seat damage.

Actuator Mounting Flange

Single-piece and two-piece ball valves are provided with an integral actuator mounting flange conforming to ISO 5211. Please note that full bore valves in sizes DN 15 to DN 25 would be supplied with mounting arrangement as per manufacturing standard.

Main features

- Full bore, floating/trunnion mounted ball valve
- Middle flange bolt connection
- Blowout proof stem
- API structure improvement
- Opening and closing positioning mechanism
- Turbine operation option
- Standard flange ends
- Butt welding ends

Product specification

Product specification	Design	Face to Face	Flange Ends	Test & Check	Marking	Supply
	GB/T 12237 JB/T 7745	GB/T 12221 JB/T 7745	JB/T 79	GB/T 26480	GB/T 12220	JB/T 7928
	API 608 API 6D	ASME B16.10 API 6D	ASME B16.5	API 598 API 6D	MSS SP-25 API 6D	API 608 API 6D

Main parts material

Parts name	Parts material					
	JB/T 7298			API 608/API 6D		
Body/Bonnet	WCB	A105	ZG1Cr18Ni9Ti	WCB	A105	CF8M
Ball	20Cr13	20Cr13	1Cr18Ni9Ti	A105/ENP	A105/ENP	A182-F316
Stem	20Cr13	20Cr13	1Cr18Ni9Ti	A182-F6a	A182-F6a	A182-F316
Seat	A105		1Cr18Ni9Ti	A105+ENP		A182-F316
Sealing ring	PTFE		R.PTFE	PTFE		R.PTFE
Packing	PTFE+FPM			ZG1Cr18Ni9Ti		
Gasket	18-8 Flexible Graphite PTFE+FPM					
Bolt	35	35	1Cr18Ni9Ti	A193-B7	A193-B7	A193-B8M
Temperature	-29~150°C		-40~121°C		-29~121°C	
Media	Water, oil, steam		Nitric acid	Water, oil, steam		Nitric acid

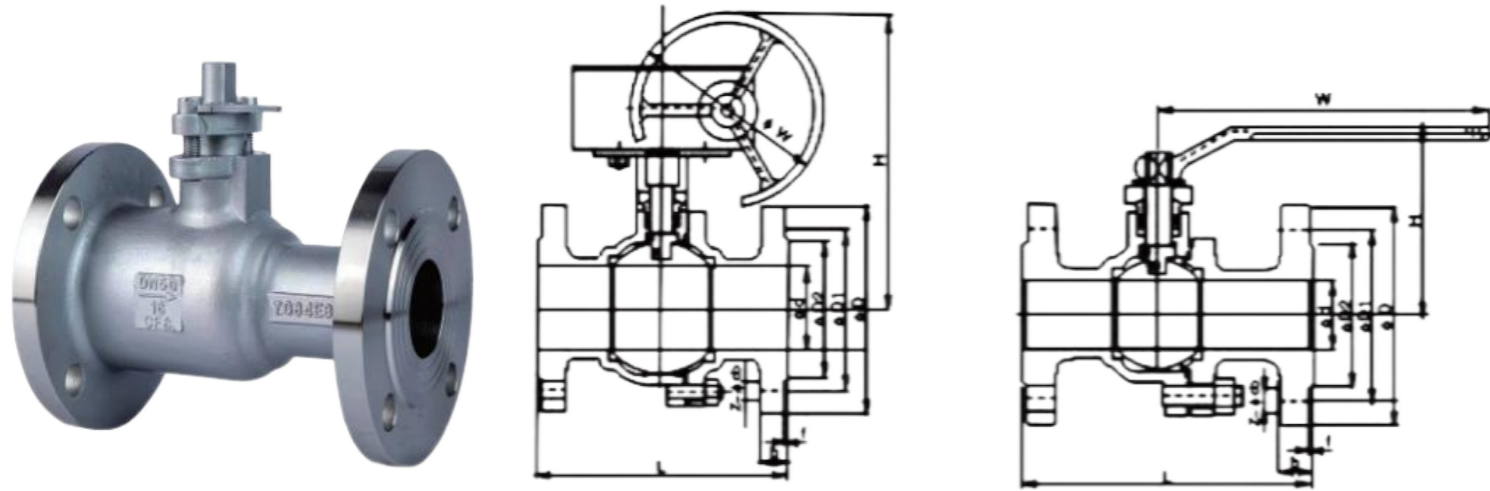

PN MPa	DN mm	L		D	D1	D2	b	f	Z-φd
		Series 1	Series 2						
1.6	15	130	102	95	65	45	14	2	4-14
	20	140	117	105	75	55	14		4-14
	25	150	127	115	85	65	14		4-14
	32	165	140	135	100	78	16		4-18
	40	180	165	145	110	85	16	3	4-18
	50	200	178	160	125	100	16		4-18
	65	220	190	180	145	120	18		4-18
	80	250	203	195	160	135	20		8-18
	100	280	305	215	180	155	20		8-18
	125	320	356	245	210	185	22		8-18
	150	360	394	280	240	210	24		8-23
	200	400	457	335	295	265	26		12-23
	250	450		405	355	320	30		12-25
	300	610		460	410	375	30		4
2.5	15	130	140	95	65	45	16	2	4-14
	20	140	152	105	75	55	16		4-14
	25	150	165	115	85	65	16		4-14
	32	165	180	135	100	78	18		4-18
	40	180	190	145	110	85	18	3	4-18
	50	200	216	160	125	100	20		4-18
	65	220	241	180	145	120	22		8-18
	80	250	283	195	160	135	22		8-18
	100	280	305	230	190	160	24		8-23
	125	320	381	270	220	188	28		8-25
	150	360	403	300	250	218	30		8-25
	200	400		360	310	278	34		12-25
	250	450		425	370	332	36		12-30
	300	610		485	430	390	40		16-30

PN MPa	DN mm	L	D	D1	D2	D6	b	f	Z-φd
4.0	15	130	95	65	45	40	16	2/4	4-14
	20	140	105	75	55	51	16	2/4	4-14
	25	150	115	85	65	58	16	2/4	4-14
	32	180	135	100	78	66	18	2/4	4-18
	40	200	145	110	85	76	18	3/4	4-18
	50	220	160	125	100	88	20	3/4	4-18
	65	250	180	145	120	110	22	3/4	8-18
	80	280	195	160	135	121	22	3/4	8-18
	100	320	230	190	160	150	24	3/4.5	8-23
	125	400	270	220	188	176	28	3/4.5	8-25
	150	400	300	250	218	204	30	3/4.5	8-25
	200	502	375	320	282	260	38	3/4.5	12-30
6.4	15	140	105	75	55	40	18	2/4	4-14
	20	152	125	90	68	51	20	2/4	4-18
	25	165	135	100	78	58	22	2/4	4-18
	32	178	150	110	82	66	24	2/4	4-23
	40	190	165	125	95	76	24	3/4	4-23
	50	216	175	135	105	88	26	3/4	4-23
	65	241	200	160	130	110	28	3/4	8-23
	80	283	210	178	140	121	30	3/4	8-23
	100	305	250	200	168	150	32	3/4.5	8-25
	125	381	295	240	202	176	36	3/4.5	8-34
	150	403	340	280	240	204	38	3/4.5	12-34

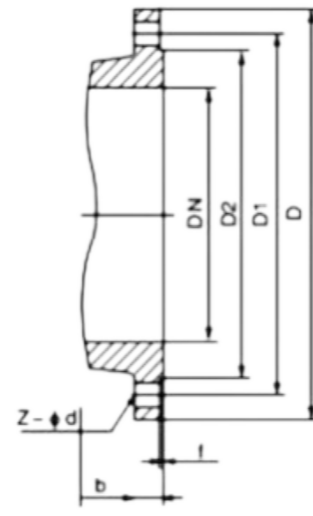
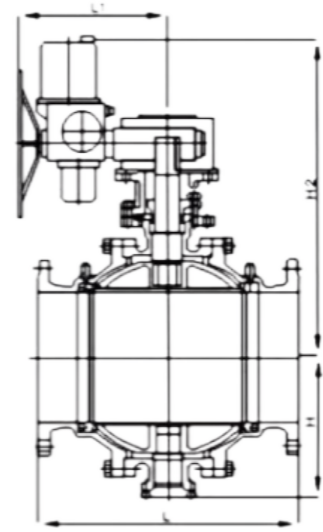
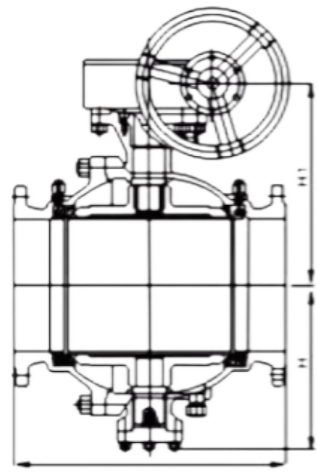

Flange ends: JB/T79.1 JB/T82.1

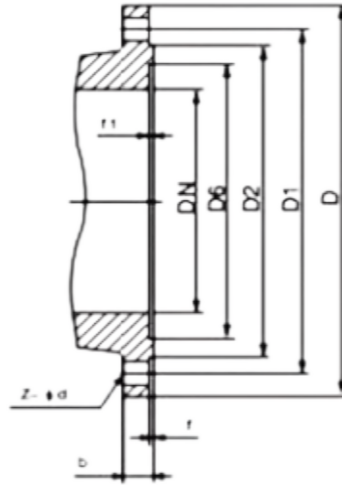
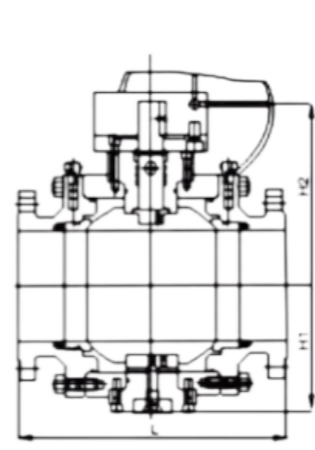
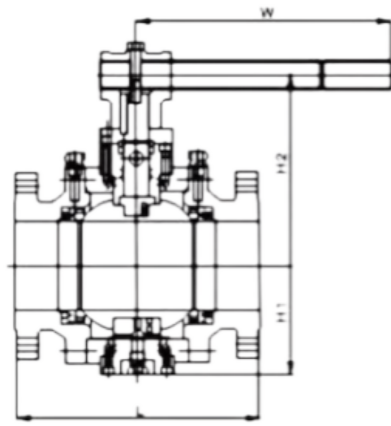

Flange ends: JB/T79.2

Steel Pipe Flange JB/T82.1

1.0MPa

DN mm	L		d1		D	D1	D2	f	b	Z-φd	Bolts
	RF	BW	Full bore	Reducing							
15	108	140	15	-	95	65	45	2	12	4-14	4-M12
20	117	152	20	-	105	75	55		14	4-14	4-M12
25	127	165	25	-	115	85	65		14	4-14	4-M12
32	140	178	32	-	135	100	78		16	4-18	4-M16
40	165	190	40	-	145	110	85	3	16	4-18	4-M16
50	178	216	50	-	160	125	100		16	4-18	4-M16
65	190	241	65	-	180	145	120		18	4-18	4-M16
80	203	283	80	65	195	160	135		20	4-18	4-M16
100	229	305	100	80	215	180	155		20	8-18	8-M16
125	356	381	125	100	245	210	185		22	8-18	8-M16
150	394	457	150	125	280	240	210		22	8-23	8-M20
200	457	521	200	150	335	295	265		22	8-23	12-M20
250	533	559	250	200	390	350	320	4	24	12-23	12-M22
300	610	635	300	250	440	400	368		26	12-23	12-M22
350	686	762	350	300	500	460	428		26	12-23	16-M22
400	762	838	400	350	565	515	482		26	12-25	16-M24
450	864	914	450	350	615	565	532		26	12-25	20-M24
500	914	991	500	400	670	620	585		28	12-25	20-M24

GB BALL VALVE

Steel Pipe Flange JB/T82.1

1.6MPa

DN mm	L		d1		D	D1	D2	f	b	Z-φd	Bolts
	RF	BW	Full bore	Reducing							
15	108	140	15	-	95	65	45	2	14	4-14	4-M12
20	117	152	20	-	105	75	55		14	4-14	4-M12
25	127	165	25	-	115	85	65		14	4-14	4-M12
32	140	178	32	-	135	100	78		16	4-18	4-M16
40	165	190	40	-	145	110	85	3	16	4-18	4-M16
50	178	216	50	-	160	125	100		16	4-18	4-M16
65	190	241	65	-	180	145	120		18	4-18	4-M16
80	203	283	80	65	195	160	135		20	8-18	8-M16
100	229	305	100	80	215	180	155		20	8-18	8-M16
125	356	381	125	100	245	210	185		22	8-18	8-M16
150	394	457	150	125	280	240	210		24	8-23	8-M20
200	457	521	200	150	335	295	265		26	12-23	12-M20
250	533	559	250	200	405	355	320		30	12-25	12-M22
300	610	635	300	250	460	410	375		30	12-25	12-M22
350	686	762	350	300	520	470	435	4	34	16-25	16-M22
400	762	838	400	350	580	525	485		36	16-30	16-M27
450	864	914	450	350	640	585	545		40	20-30	20-M27
500	914	991	500	400	705	650	608		44	20-34	20-M30
600	1067	1143	600	500	840	770	718	5	48	20-41	20-M36
700	1245	1346	700	600	910	840	788		50	24-41	20-M36
800					1020	950	898		52	24-41	20-M36

GB BALL VALVE

Steel Pipe Flange JB/T79.1

2.5MPa

DN mm	L		d1		D	D1	D2	f	b	Z-φd	Bolts
	RF	BW	Full bore	Reducing							
15	140	140	15	-	95	65	45	2	16	4-14	4-M12
20	152	152	20	-	105	75	55		16	4-14	4-M12
25	165	165	25	-	115	85	65		16	4-14	4-M12
32	178	178	32	-	135	100	78		18	4-18	4-M16
40	190	190	40	-	145	110	85	3	18	4-18	4-M16
50	216	216	50	-	160	125	100		20	4-18	4-M16
65	241	241	65	-	180	145	120		22	8-18	8-M16
80	283	283	80	65	195	160	135		22	8-18	8-M16
100	305	305	100	80	230	190	160		24	8-23	8-M20
125	381	381	125	100	270	220	188		28	8-25	8-M22
150	403	457	150	125	300	250	218		30	8-25	8-M22
200	502	521	200	150	360	310	278		34	12-25	12-M22
250	568	559	250	200	425	370	332		36	12-30	12-M27
300	648	638	300	250	485	430	390		40	16-30	16-M27
350	762	762	350	300	550	490	448	4	44	16-34	16-M30
400	838	838	400	350	610	550	505		48	16-34	16-M30
450	914	914	450	400	660	600	555		50	20-34	20-M30
500	991	991	500	450	730	660	610		52	20-41	20-M36
600	1143	1143	600	500	840	770	718	5	56	20-41	20-M36
700	1346	1346	700	600	955	875	815		60	24-48	24-M42
800					1070	990	930		64	24-48	24-M42

GB BALL VALVE

Steel Pipe Flange JB/T79.2

4.0MPa

GB BALL VALVE

Steel Pipe Flange JB/T79.2

6.4MPa

DN mm	L		d1		D	D1	D2	D6	f	b	Z-φd	Bolts
	RF	BW	Full bore	Reducing								
15	140	140	15	-	95	65	45	40	2/4	16	4-14	4-M12
20	152	152	20	-	105	75	55	51		16	4-14	4-M12
25	165	165	25	-	115	85	65	58		16	4-14	4-M12
32	178	178	32	-	135	100	78	66		18	4-18	4-M16
40	190	190	40	-	145	110	85	76	3/4	18	4-18	4-M16
50	216	216	50	-	160	125	100	88		20	4-18	4-M16
65	241	241	65	-	180	145	120	110		22	8-18	8-M16
80	283	283	80	65	195	160	135	121		22	8-18	8-M16
100	305	305	100	80	230	190	160	150	3/4.5	24	8-23	8-M20
125	381	381	125	100	270	220	188	176		28	8-25	8-M22
150	403	457	150	125	300	250	218	204		30	8-25	8-M22
200	502	521	200	150	375	320	282	260	3/4.5	38	12-30	12-M27
250	568	559	250	200	445	385	345	313		42	12-34	12-M30
300	648	638	300	250	510	450	408	364	4/4.5	46	16-34	16-M30
350	762	762	350	300	570	510	465	422	4/5	52	16-34	16-M30
400	838	838	400	350	655	585	535	474		58	16-41	16-M30
450	914	914	450	400	680	610	560	524		60	20-41	20-M36
500	991	991	500	450	755	670	612	576		62	20-48	20-M42
600	1143	1143	600	500	890	795	730	678	5/6	62	20-54	20-M48
700	1346	1346	700	600	955	900	835	768		68	24-54	24-M48
800					1135	1030	960	876		76	24-58	24-M52

DN mm	L		d1		D	D1	D2	D6	f	b	Z-φd	Bolts
	RF	BW	Full bore	Reducing								
15	140	140	15	-	95	65	45	40	2/4	16	4-14	4-M12
20	152	152	20	-	105	75	55	51		16	4-14	4-M12
25	165	165	25	-	115	85	65	58		16	4-14	4-M12
32	178	178	32	-	135	100	78	66		18	4-18	4-M16
40	190	190	40	-	145	110	85	76	3/4	18	4-18	4-M16
50	216	216	50	-	160	125	100	88		20	4-18	4-M16
65	241	241	65	-	180	145	120	110		22	8-18	8-M16
80	283	283	80	65	195	160	135	121		22	8-18	8-M16
100	305	305	100	80	230	190	160	150	3/4.5	24	8-23	8-M20
125	381	381	125	100	270	220	188	176		28	8-25	8-M22
150	403	457	150	125	300	250	218	204		30	8-25	8-M22
200	502	521	200	150	375	320	282	260	3/4.5	38	12-30	12-M27
250	568	559	250	200	445	385	345	313		42	12-34	12-M30
300	648	638	300	250	510	450	408	364	4/4.5	46	16-34	16-M30
350	762	762	350	300	570	510	465	422	4/5	52	16-34	16-M30
400	838	838	400	350	655	585	535	474		58	16-41	16-M30
450	914	914	450	400	680	610	560	524		60	20-41	20-M36
500	991	991	500	450	755	670	612	576		62	20-48	20-M42
600	1143	1143	600	500	890	795	730	678	5/6	62	20-54	20-M48
700	1346	1346	700	600	955	900	835	768		68	24-54	24-M48
800					1135	1030	960	876		76	24-58	24-M52

SIDE MOUNTED ECCENTRIC SEMI BALL VALVE

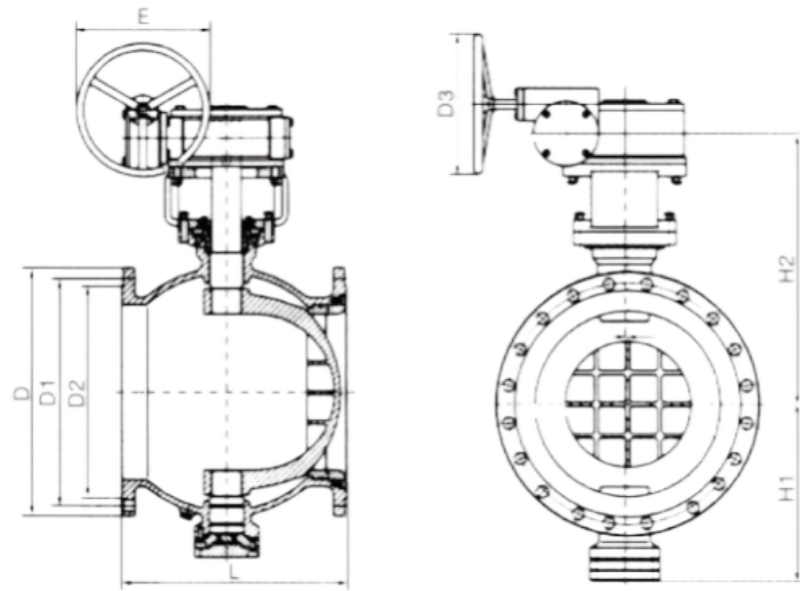

1.6MPa

DN mm	L	D	D1	D2	C	f	n-L	H1	H2	D3	B	E
40	125	150	110	84	18	2	4-18	60	190	160	143	130
50	140	165	125	99	20	2	4-18	70	200	160	143	130
65	178	185	145	118	20	2	4-18	80	220	240	162	188
80	190	200	160	132	20	2	8-18	95	250	240	162	188
100	200	220	180	156	22	2	8-18	120	280	280	185	220
125	254	250	210	184	22	2	8-18	140	330	320	214	260
150	267	285	240	211	24	2	8-22	160	365	320	214	260
200	292	340	295	266	24	2	12-22	200	425	350	234	295
250	330	405	355	319	26	2	12-26	240	480	400	273	340
300	390	460	410	370	28	2	12-26	262	550	400	273	340
350	430	520	470	429	30	2	16-26	300	600	400	373	410
400	530	580	525	480	32	2	16-30	350	657	500	373	410
450	580	640	585	548	40	2	20-30	390	657	500	373	410
500	630	715	650	609	44	2	20-33	420	713	500	353	438
600	800	840	770	720	54	2	20-36	500	793	500	353	438
700	900	910	840	794	40	5	24-36	575	875	500	353	480
800	1000	1025	950	901	42	5	24-39	650	955	500	353	480

SIDE MOUNTED ECCENTRIC SEMI BALL VALVE

2.5MPa

DN mm	L	D	D1	D2	C	f	n-L	H1	H2	D3	B	E
40	125	150	110	84	18	2	4-18	60	190	160	143	130
50	140	165	125	99	20	2	4-18	70	200	160	143	130
65	178	185	145	118	22	2	8-18	80	220	240	162	188
80	190	200	160	132	24	2	8-18	95	250	240	162	188
100	200	235	190	156	24	2	8-22	120	280	280	185	220
125	254	270	220	184	26	2	8-26	140	330	320	214	260
150	267	300	250	211	28	2	8-26	160	365	320	214	260
200	292	360	310	274	30	2	12-26	200	425	350	234	295
250	330	425	370	330	32	2	12-30	240	480	400	273	340
300	390	485	430	389	34	2	16-30	262	550	400	273	340
350	430	555	490	448	38	2	16-33	300	600	400	373	410
400	530	620	550	503	40	2	16-36	350	657	500	373	410
450	580	670	600	548	46	2	20-36	390	657	500	373	410
500	630	730	660	609	48	2	20-36	420	713	500	353	438
600	800	845	770	720	58	2	20-39	500	793	500	353	438
700	900	960	875	820	50	5	24-42	575	875	500	353	480
800	1000	1085	990	928	54	5	24-48	650	955	500	353	480

MOUNTED ECCENTRIC SEMI BALL VALVE

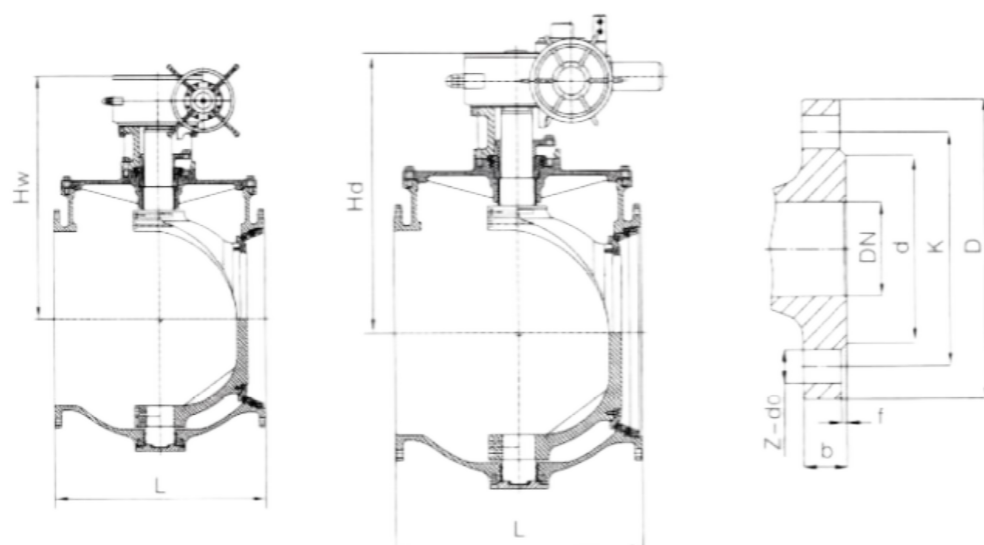

1.6MPa

DN mm	L	D	K	d	b	f	Z-d0	Hw	Hd
100	229	220	180	156	22	2	8-18	330	380
125	254	250	210	184	22	2	8-18	345	405
150	267	285	240	211	24	2	8-23	370	440
200	292	340	295	266	24	2	12-23	405	470
250	330	405	355	319	26	2	12-26	480	540
300	356	460	410	370	28	2	12-26	520	580
350	430	520	470	429	30	2	16-26	570	630
400	530	580	525	480	32	2	16-30	630	710
450	580	640	585	548	40	2	20-30	690	770
500	660	715	650	609	44	2	20-33	740	820
600	840	840	770	720	48	2	20-36	840	940
700	900	910	840	794	50	5	24-36	960	1040
800	1000	1025	950	901	52	5	24-39	1080	1180
900	1100	1125	1050	1001	54	5	28-39	1190	1280
1000	1200	1255	1170	1112	56	5	28-42	1310	1420
1100	1250	1370	1280	1222	56	5	28-42	1390	1480
1200	1300	1485	1390	1328	58	5	32-48	1420	1530
1400	1500	1685	1590	1530	60	5	36-48	1540	1650
1600	1800	1930	1820	1750	68	5	40-55	1660	1750
1800	2000	2130	2020	1950	68	5	44-55	1790	1860
2000	2200	2345	2230	2150	70	5	48-60	1920	1990

V PORT BALL VALVE

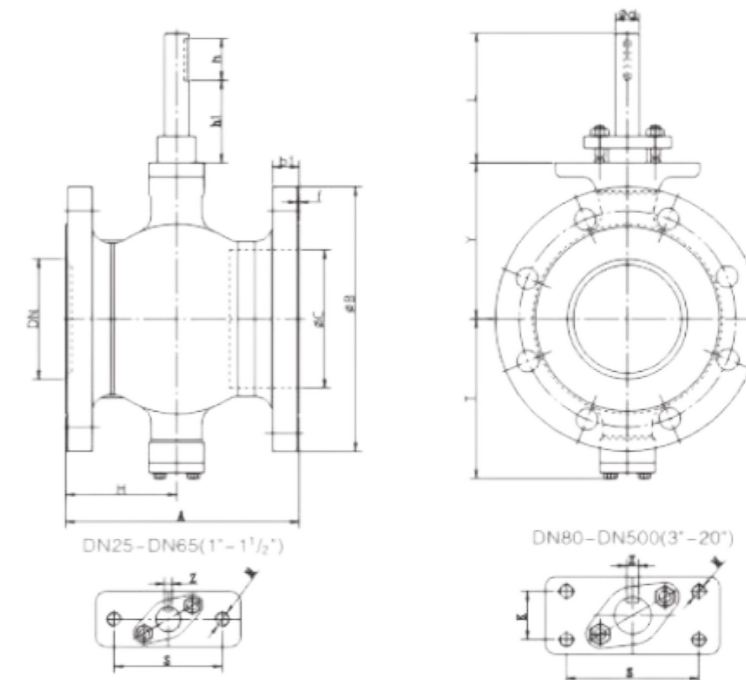

2.5MPa

DN mm	A	B	b1	f	C	T	Y	L	φd	h	S	K	M	Z
25	102	115	16	2	40	88	86	75	20	35	90	28	4-10	6
32	102	140	18	2	48	90	90	75	20	35	90	28	4-10	6
40	114	150	18	2	56	95	93	80	25	40	90	28	4-10	8
50	124	165	20	2	65	98	98	80	25	40	90	28	4-10	8
65	145	185	22	2	81	128	125	95	30	50	110	40	4-12	8
80	165	200	24	2	95	130	128	95	30	50	110	40	4-12	8
100	194	235	24	2	115	142	142	95	30	50	110	40	4-12	8
125	194	270	26	2	138	175	170	100	40	60	135	40	4-16	12
150	229	300	28	2	170	215	215	125	50	60	140	64	4-16	14
200	243	360	30	2	208	228	228	125	50	60	140	64	4-16	14
250	297	425	32	2	265	260	260	150	60	80	170	80	4-20	18
300	338	485	34	2	320	310	310	150	60	80	170	80	4-20	18

V PORT BALL VALVE

4.0MPa

DN mm	A	B	b1	f	C	T	Y	L	φd	h	S	K	M	Z
25	102	115	16	2	40	88	86	75	20	35	90	28	4-10	6
32	102	140	18	2	48	90	90	75	20	35	90	28	4-10	6
40	114	150	18	2	56	95	93	80	25	40	90	28	4-10	8
50	124	165	20	2	65	98	98	80	25	40	90	28	4-10	8
65	145	185	22	2	81	128	125	95	30	50	110	40	4-12	8
80	165	200	24	2	95	130	128	95	30	50	110	40	4-12	8
100	194	235	24	2	115	142	142	95	30	50	110	40	4-12	8
125	194	270	26	2	138	175	170	100	40	60	135	40	4-16	12
150	229	300	28	2	170	215	215	125	50	60	140	64	4-16	14
200	243	375	34	2	208	228	228	125	50	60	140	64	4-16	14
250	297	450	38	2	265	260	260	150	60	80	170	80	4-20	18
300	338	515	42	2	320	310	310	150	60	80	170	80	4-20	18

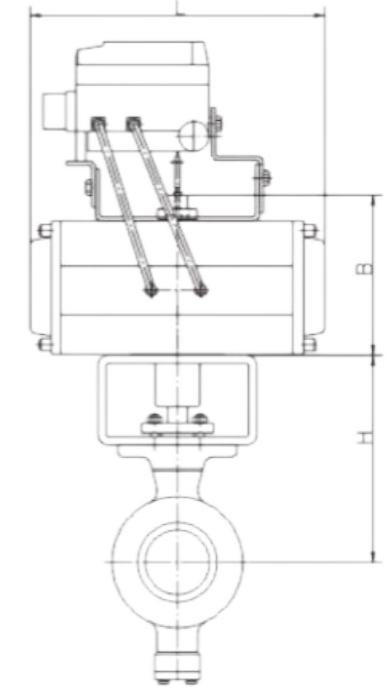
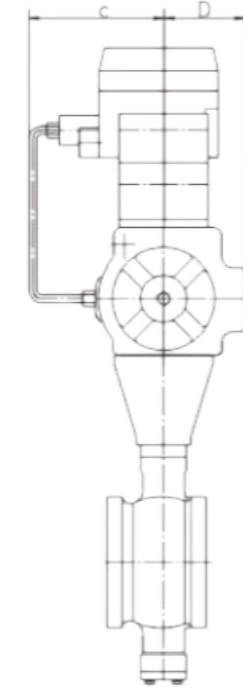

6.4MPa

DN mm	A	B	b1	f	C	T	Y	L	φd	h	S	K	M	Z
25	145	140	24	2	42	100	105	80	25	40	90	28	4-10	8
32	145	155	26	2	50	105	110	80	25	40	90	28	4-10	8
40	170	170	26	2	58	120	120	95	30	50	110	40	4-12	8
50	170	180	26	2	68	130	135	95	30	50	110	40	4-12	8
65	200	205	26	2	82	140	140	100	40	60	135	40	4-16	12
80	200	215	28	2	95	153	150	100	40	60	135	40	4-16	12
100	254	250	30	2	120	160	170	100	40	60	135	40	4-16	12
125	265	295	34	2	138	190	200	125	50	60	140	64	4-16	14
150	280	345	36	2	170	230	236	150	50	80	170	80	4-20	18
200	360	415	42	2	218	263	273	170	70	90	190	90	4-24	20
250	390	470	46	2	275	320	320	170	70	90	190	90	4-24	20
300	420	530	52	2	320	375	410	180	80	100	190	90	4-24	22

DN mm	L	B	H	C	D	D1
25	168	108	163	120	36	85
32	168	108	168	120	36	85
40	204	129	170	130	46	85
50	262	137	180	130	50	85
65	262	137	195	130	50	85
80	268	153	210	145	56	90
100	268	153	220	145	56	102
125	300	175	235	160	68	97
150	390	192	270	160	75	129
200	460	217	300	175	87	123
250	525	260	375	195	103	149
300	600	319	420	220		148
350	720	356	500	250		179
400	740	378	550	260		180
450	740	378	650	260		230
500	860	432	720	260		280

Reducing exhaust direct buried ball valve (long type)

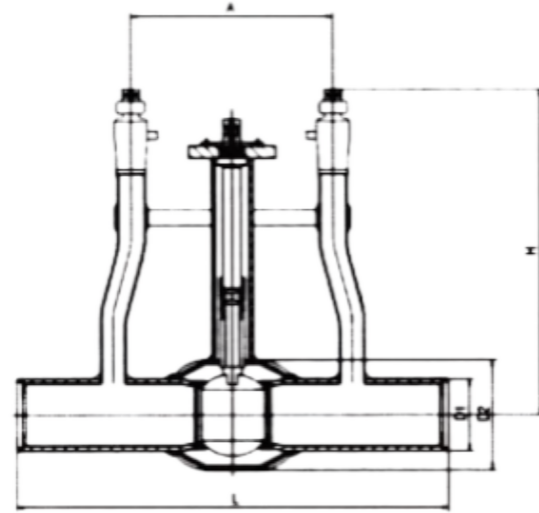

DN mm	Model	D1		D2	A	L
		EN	GOST			
50	2R0502H2T	60.3	57	89	300	1000
65	2R0652H2T	76.1	76.3	114	300	1000
80	2R0802H2T	88.9	89.1	140	300	1000
100	2R1002H2T	114.3	108	165	300	1000
125	2R1252H2T	139.7	133	180	400	1000
150	2R1502H2T	168.3	159	219	400	1000
200	2R2002H2T	219.1	219.1	267	400	1000
250	2R2502H2T	273.1	273.1	355	500	1000
300	2R3002H2T	323.9	323.9	457	500	1100
350	2R3502H2T	355.6	377	508	500	-
400	2R4002H2T	406.4	426	558	500	1360
450	2R4502H2T	457	478	558	500	-
500	2R5002H2T	508	530	660	600	1800
600	2R6002H2T	609.6	630	813	650	1900
700	2R7002H2T	712.2	720	1016	700	2100
800	2R8002H2T	812.8	820	1095	800	2350
900	2R9002H2T	914.4	920	1245	800	2610

Reducing exhaust direct buried ball valve (short type)

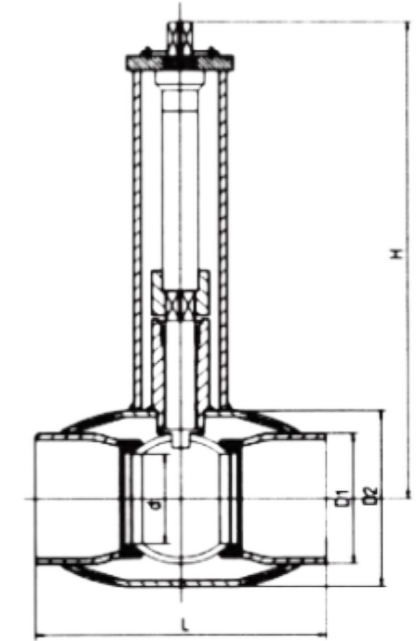

DN mm	Model	D1		D2	L	
		EN	GOST		S	L
50	1R0502H0V	60.3	57	89	300	1000
65	1R0652H0V	76.1	76.3	114	300	1000
80	1R0802H0V	88.9	89.1	140	300	1000
100	1R1002H0V	114.3	108	165	325	1000
125	1R1252H0V	141.3	133	180	325	1000
150	1R1502H0V	168.3	159	219	350	1000
200	1R2002H0V	219.1	219.1	267	400	1000
250	1R2502H0V	273.1	273.1	355	560	1000
300	1R3002H0V	323.9	323.9	457	635	1100
400	1R4002H0V	406.4	426	558	760	1360
500	1R5002H0V	508	530	660	910	1800
600	1R6002H0V	610	630	812	1065	1900
700	1R7002H0V	711	720	1016	1346	2100
800	1R8002H0V	813	820	1130	1524	2350
900	1R9002H0V	914	920	1245	1727	2610

Full bore exhaust direct buried welded ball valve (long type)

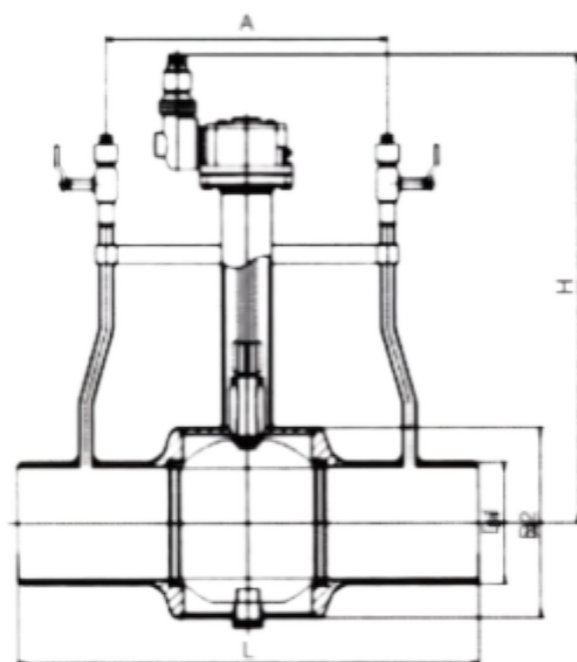

DN mm	Model	D	A	L
50	2F0502H2T	114	300	1000
65	2F0652H2T	140	300	1000
80	2F0802H2T	165	300	1000
100	2F1002H2T	216	300	1000
150(T)	2F1252H2T	267	400	1000
150(V)	2F1502H2T	300	400	1000
200	2F2002H2T	356	400	1100
250	2F2502H2T	457	500	1100
300	2F3002H2T	508	500	1230
400	2F4002H2T	660	500	1550
500	2F5002H2T	812	600	1700
600	2F6002H2T	1016	700	2000
700	2F7002H2T	1130	700	2195
800	2F8002H2T	1245	800	2300
900	2F9002H2T	1415	900	2550

Full bore exhaust direct buried welded ball valve (short type)

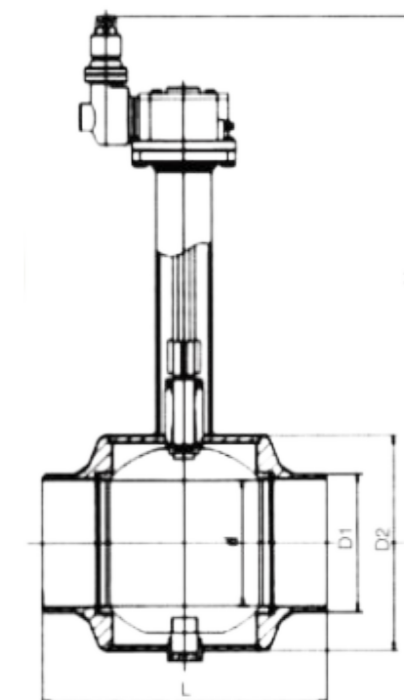

DN mm	Model	D1		D2	L
		EN	GOST		
50	1F0502H0T	60.3	57	114	300
65	1F0652H0T	76.1	76.3	140	300
80	1F0802H0T	88.9	89.1	165	300
100	1F1002H0T	114.3	108	216	325
125	1F1252H0T	139.7	133	219	350
150	1F1502H0T	168.3	159	267	490
200	1F2002H0T	219.1	219.1	356	550
250	1F2502H0T	273.1	273.1	457	580
300	1F3002H0T	323.9	323.9	508	630
350	1F3502H0T	355.6	323.9	559	762
400	1F4002H0T	406.4	426	660	838
500	1F5002H0T	508	530	812	970
600	1F6002H0T	610	630	1016	1140
700	1F7002H0T	711	720	1130	1346
800	1F8002H0T	813	820	1245	1524
900	1F9002H0T	914	920	1415	1727